

(WE RESERVE THE RIGHT TO CHANGE DESIGN AND TECHNICAL DATA FURNISHED HERE DUE TO CONTINUOUS PRODUCT DEVELOPMENT.)

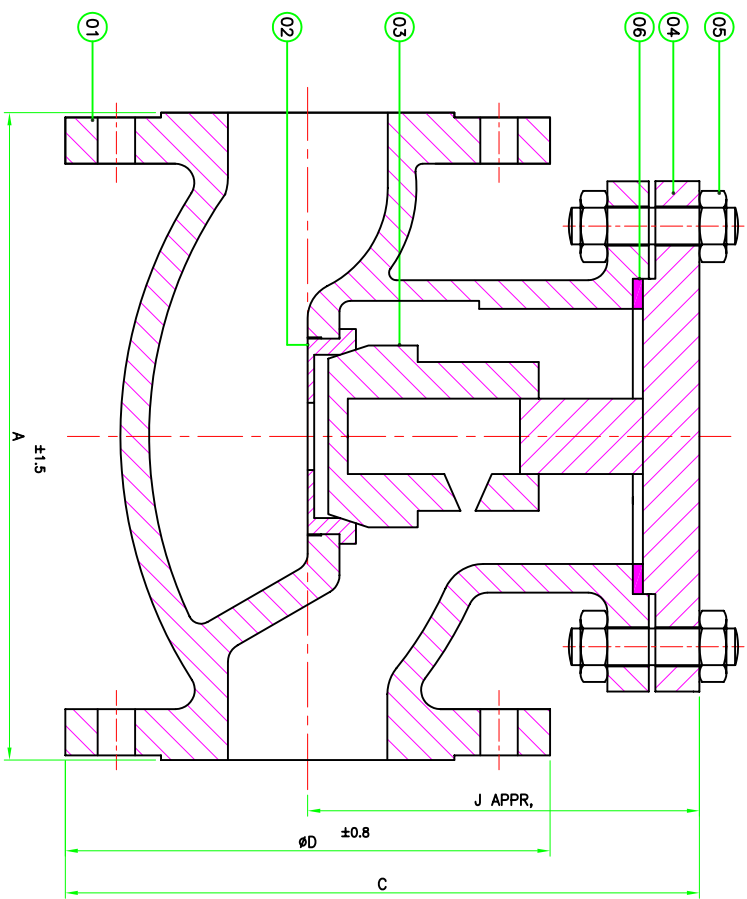

1	SIZE	A	B	C	ØD	E
2	40	200	105	180	150	110
3	50	230	118	200	165	125
4	65	290	128	220	185	145
5	80	310	140	240	200	160
6	100	350	158	275	235	190
7	125	400	175	310	270	220
8	150	480	195	345	300	250
9	200	600	243	430	375	320
10	250	730	334	559	450	385

A	B	C	D	E	F	G	H	I	J
ND16 / ND40									

NO.	DESCRIPTION	QTY.	MATL.
1	BODY	1	C.S.(ASTM B 216 Gr. WCB)
			C.I. (IS 210 Gr. FG 220)
			S.S.(ASTM A 351 CF8/CF8M/CN7M)
2	SEAT	1	S.S. 13% Cr./304/316/A20
3	VALVE DISC	1	S.S. 13% Cr./304/316/A20
4	COVER	1	C.S.(ASTM B 216 Gr. WCB)
			C.I. (IS 210 Gr. FG 220)
			S.S.(ASTM A 351 CF8/CF8M/CN7M)
5	STUD & NUT	Req.	ASTM A 193 Gr. B7
			ASTM A 194 Gr. 2H
6	GASKET	1	SPIRAL WOUND S.S.304 + CAF FILLER

**TECHNICAL DATA**

MFG. STD. :- BS 1868/API 6D  
 INSP. STD. :- API 598/BS 5148  
 END TO END :- ND-16/ND-40  
 ENDS CONNECTION : DIN 2533/2543/2535/2545/BS 1560

**PRESSURE TEST (HYDRAULIC):-**

ND16	ND40
BODY :- 32 KG/CM2 (g)	BODY : 80 KG/CM2 (g)
SEAT :- 16 KG/CM2 (g)	SEAT : 40 KG/CM2 (g)
SEAT ( PNEUMATIC ) :- 7 KG/CM2 (g)	SEAT ( PNEUMATIC ) : 7 KG/CM2 (g)

UNSPECIFIED TOLERANCE FOR MACHINED DIM.	DESCRIPTION
0-75 ± 0.2	ASLY OF LIFT TYPE NON RETURN VALVE
75-300 ± 0.4	
300-600 ± 0.6	
ABOVE 600 ± 0.75	

ND 16,ND 40	25 TO 250 (mm)	ALL DIMENSIONS ARE IN M.M.	MATERIAL
END CONNECTION	STANDARD	UNLESS OTHERWISE SPECIFIED	AS STATED
FLANGED ENDS	BS 1988	REMOVE SHARP CORNERS	DRN. DATE
<b>MANUFACTURERS &amp; EXPORTER</b> <b>M.KUMAR TECHNOCRATES</b> SR/9,RAMBHA COMPLEX, ASHRAM ROAD, AHMEDABAD - 380 014,(GUJARAT) INDIA Phone:-0091-79-275440287. Fax:-0091-79-275445519. E-mail:-info@mktechdivides.com Website:-http://www.mktechdivides.com		SCALE	N.T.S.
		VALVE TYPE	GHV
		CHECK VALVE	CHD.
		PROJECTION	APPD.
		THIRD ANGLE	DATE
		SHEET No.	DRW. No.
		01 OF 01	AMTECH
			REV.
			00